

STATION 0+65
TYPICAL CROSS SECTION
FLOTATION BAFFLE

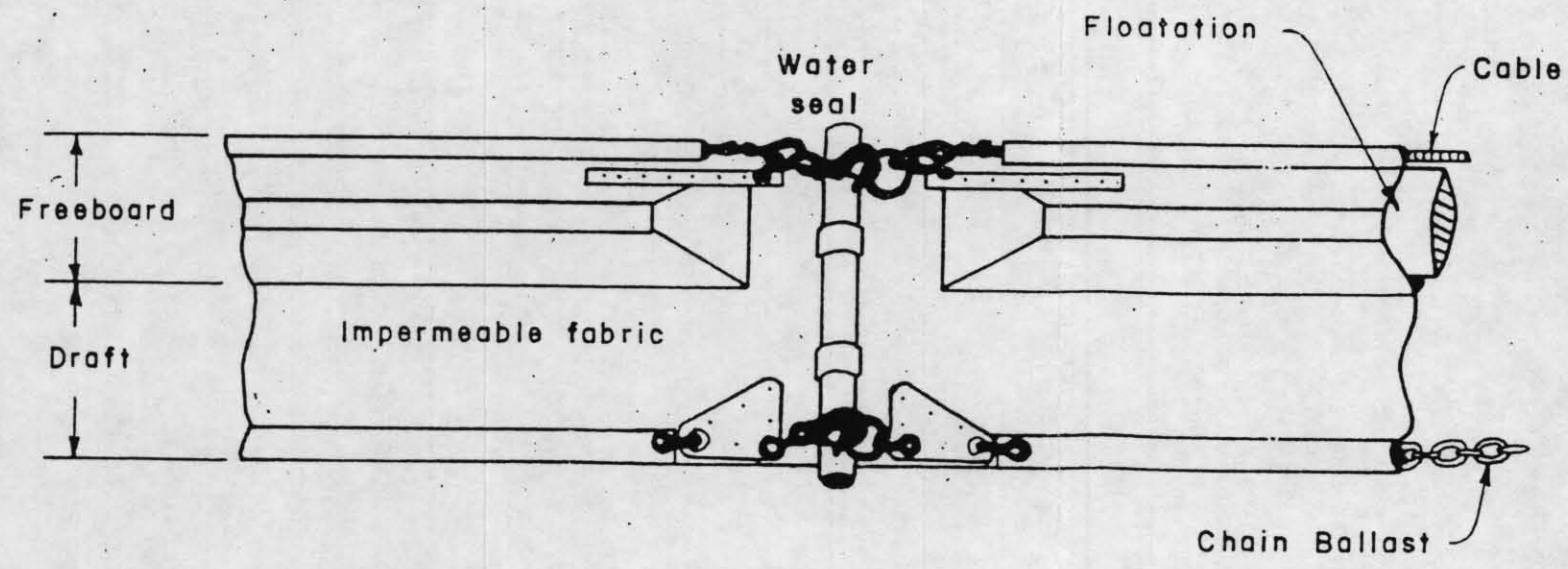

ELEVATION VIEW
FLOTATION BAFFLE

Approved by	_____	Date	_____
Checked	_____	Date	_____
Reviewed C.S. & C.M.	_____	Date	1/99
Drawn C.M.	_____	Date	2/99
Reviewed C.M.	_____	Date	3/01
Checked	_____	Date	_____

USDA NRCS
 Natural Resources Conservation Service

REVISED SECTION AND DETAIL
BLUE VALLEY AND WETLAND
 ELK COUNTY, PENNSYLVANIA

Drawing No. _____
 Sheet No. 4 of 7

DEP-1 N=6119.9990 E=19583.4856 ELEV.=1560.93
 DEP-2 N=6326.8120 E=19532.2240 ELEV.=1564.42
 0+00 N=6065.0000 E=19619.0000
 1+15 N=5968.8974 E=19877.3241
 2+50 N=5852.4502 E=19945.6423



Date	1/99	2/99	3/01
Approved by			
Designed G.S. & C.M.			
Drawn C.M.			
Reviewed C.M.			
Checked			

USDA NRCS
 Natural Resources Conservation Service

REVISED FINAL PLANVIEW
BLUE VALLEY AND WETLAND
 ELK COUNTY, PENNSYLVANIA

Drawing No. _____
 Sheet No. 3 of 7

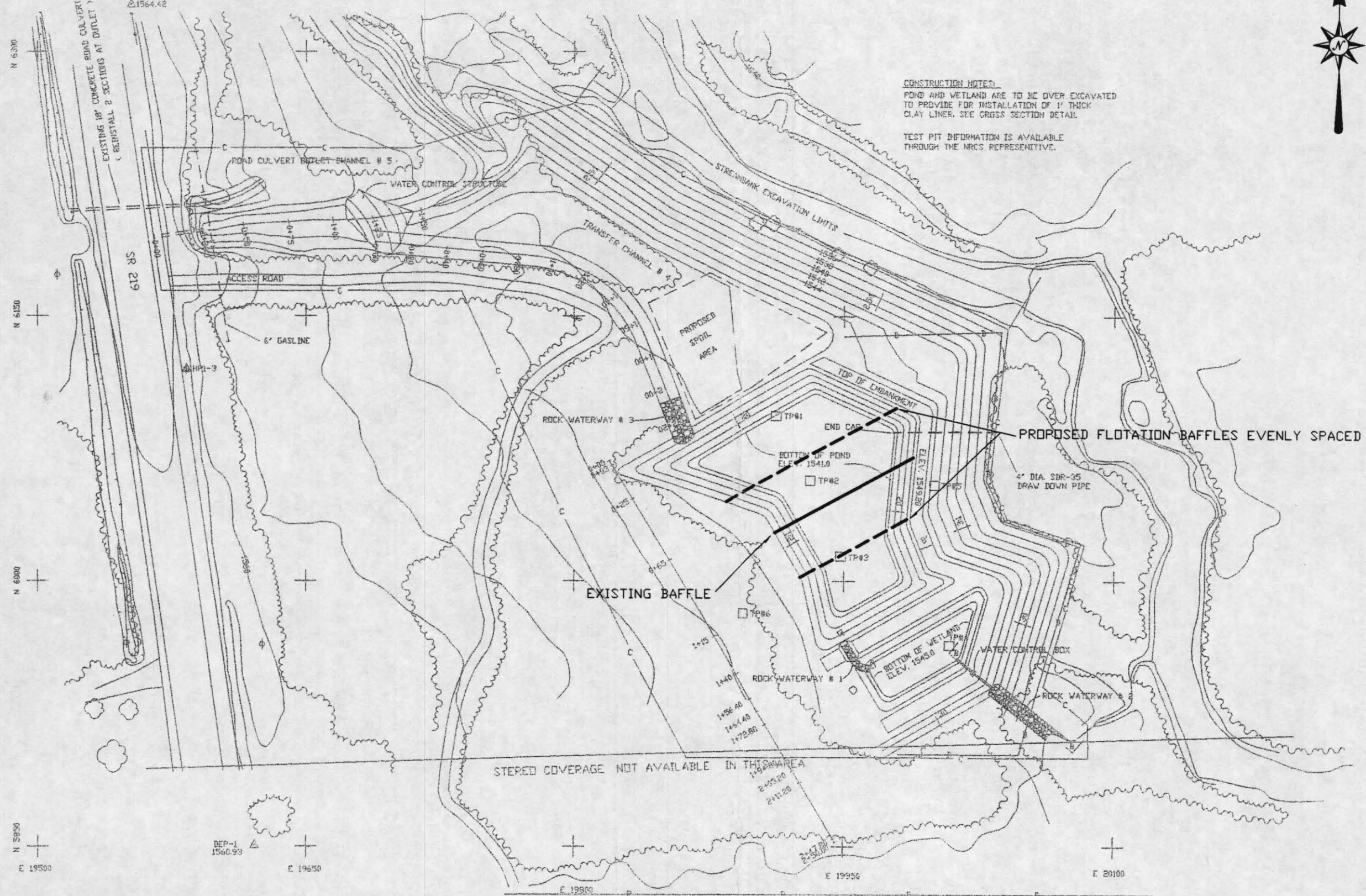

CONSTRUCTION NOTES:
 POND AND WETLAND ARE TO BE OVER EXCAVATED TO PROVIDE FOR INSTALLATION OF 1\"/>

EXISTING BAFFLE

PROPOSED FLOTATION BAFFLES EVENLY SPACED

STERED COVERAGE NOT AVAILABLE IN THIS AREA

LITTLE TOBY CREEK WATERSHED PROJECT
 TOPOGRAPHY BY: KEVIN ENGINEERS, INC. AN EADS GROUP CO. USING PHOTOGRAPHY DATED 11/29/96.
 JOB# 1159616025 SCALE 1"=30' CONTOUR INTERVAL 2' HORTON & FOX TWP. ELK COUNTY

IT IS THE DUTY OF CONTRACTORS TO COMPLY WITH THE PROVISIONS OF PENNSYLVANIA ACT 187 (1996) BEFORE PERFORMING ANY EXCAVATION WORK.
 SN# 3291257 DATE: 11/24/98

- LEGEND**
- C — CONSTRUCTION LIMIT
 - B — RALE FILTER BARRIER
 - P — APPARENT PROPERTY LINE
 - X — EXISTING 18\"/>

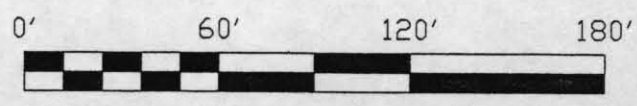

Columbia Office JAN22'091049